

Colorado Allergy and Anaphylaxis Emergency Care Plan Directions

AUVI-Q™ (EPINEPHRINE INJECTION, USP) DIRECTIONS

1. Remove the outer case of AUVI-Q. This will automatically activate the voice instructions.
2. Pull off red safety guard.
3. Place black end against mid-outer thigh.
4. Press firmly and hold for 5 seconds.
5. Remove from thigh.

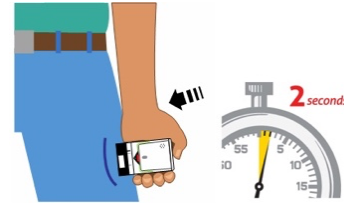

ADRENALICK® (EPINEPHRINE INJECTION, USP) AUTO-INJECTOR DIRECTIONS

1. Remove outer case.
2. Remove grey caps labeled "1" and "2".
3. Place red rounded tip against mid-outer thigh.
4. Press down hard until needle enters thigh.
5. Hold in place for 10 seconds. Remove from thigh.

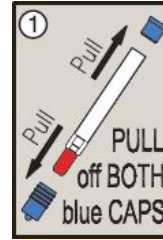

MYLAN EPIPEN® AUTO-INJECTOR DIRECTIONS

1. Remove the EpiPen Auto-Injector from the clear carrier tube.
2. Remove the blue safety release by pulling straight up without bending or twisting it.
3. Place and firmly push orange tip against mid-outer thigh until it 'clicks'.
4. Hold firmly in place for 3 seconds (count slowly 1, 2, 3).
5. Remove auto-injector from the thigh and massage the injection area for 10 seconds.

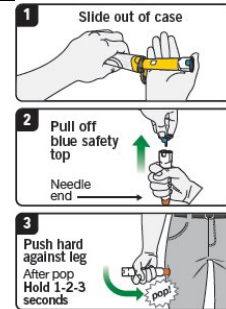

TEVA Generic EPIPEN® AUTO-INJECTOR DIRECTIONS

1. Quickly twist off the yellow or green cap in the direction of the "twist arrow" to remove it.
2. Grasp the auto-injector in your fist with the orange tip (needle end) pointing downward. With your other hand, pull off the blue safety release.
3. Place the orange tip against the mid-outer thigh (upper leg) at a right angle to the thigh, push the auto-injector firmly until it 'clicks'.
4. Hold firmly in place for 3 seconds (count slowly 1, 2, 3).
5. Remove auto-injector from the thigh and massage the injection area for 10 seconds.



PLACE AND PUSH



HOLD FIRMLY



REMOVE AUTO-INJECTOR & MASSAGE AREA

neffy® NASAL SPRAY DIRECTIONS

1. Pull open the packaging to remove the neffy nasal spray device.
2. Hold device as shown. Hold the device with your thumb on the bottom of the plunger and a finger either of the nozzle.
3. Insert the nozzle into a nostril until your fingers touch the nose. Keep the nozzle straight into the nose pointed toward the forehead.
4. Press plunger up firmly until it snaps up and sprays liquid into the nostril.

First Dose

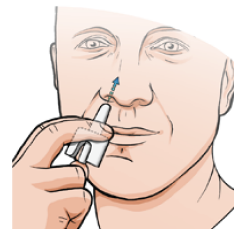

Second Dose in the Same Nostril

